

# Shiplap Wall

*Assembly & Installation*

  
**HANSEN WHOLESALE**  
[www.hansenwholesale.com](http://www.hansenwholesale.com)  
1-800-201-1193

# Understanding the CAD drawing

Each Shiplap Wall will include a CAD drawing. The sketch will show the panel layout as well as number the panels for their intended location. Labels on the sketch will correspond to labels attached to each trim piece and individual panel.

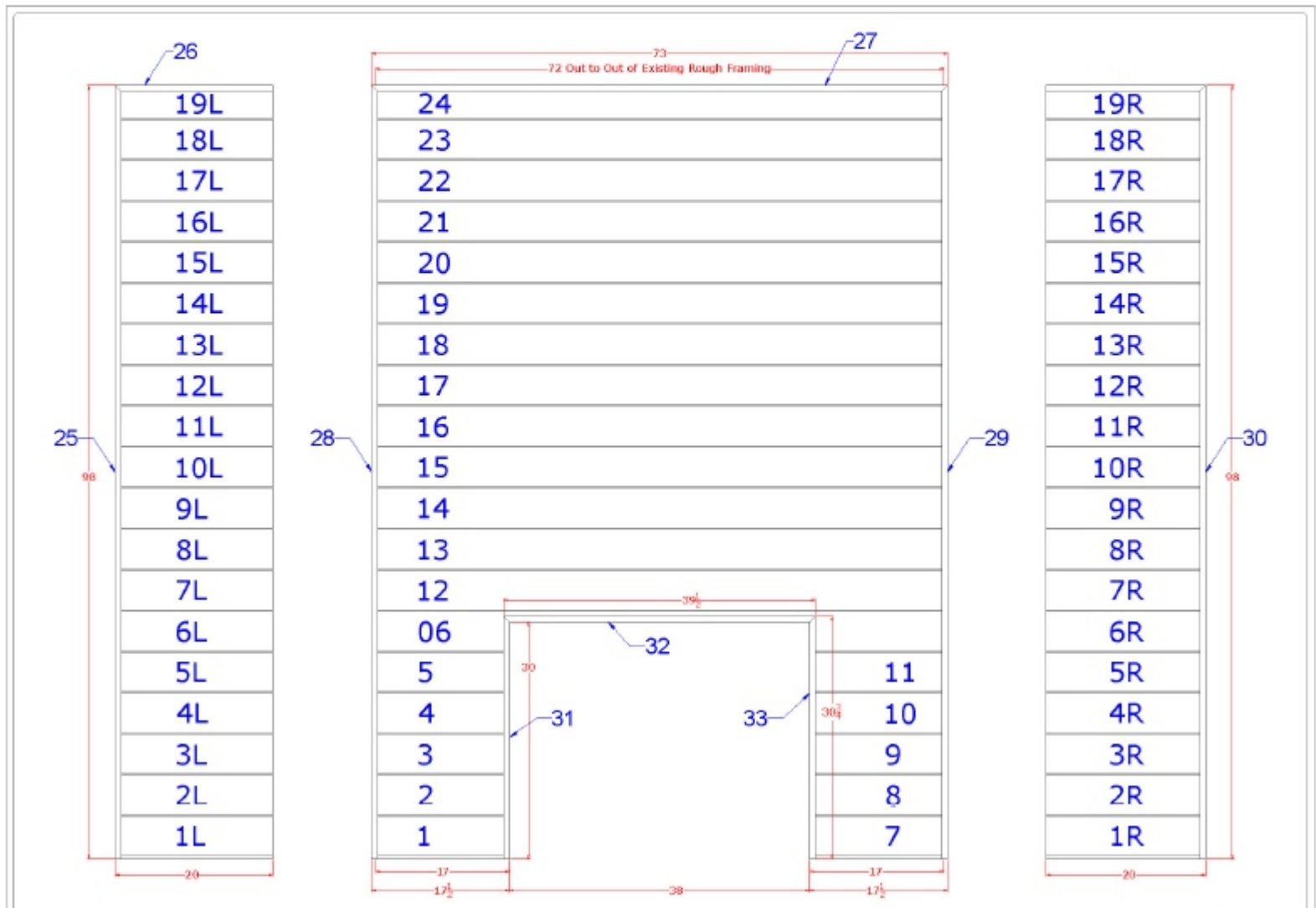

## Trim System

1. Install all “J” trims along the outside perimeter of the wall, and the inside perimeter of any openings. There are no perimeter trims along the floor, the first shiplap panel will rest on the floor. Refer to the measurement sheet for the locations of the “J” trims.

**Important Note!** In applications with return walls, place the outside perimeter vertical “J” trim 1/2” beyond the corner to allow the return panels to fit tight to the back of the “J” trim (*See Figure A*).

*Note: the shiplap wall panels will fit into the “J” trims and give final support for the trims. Over securing the trims is not necessary.*

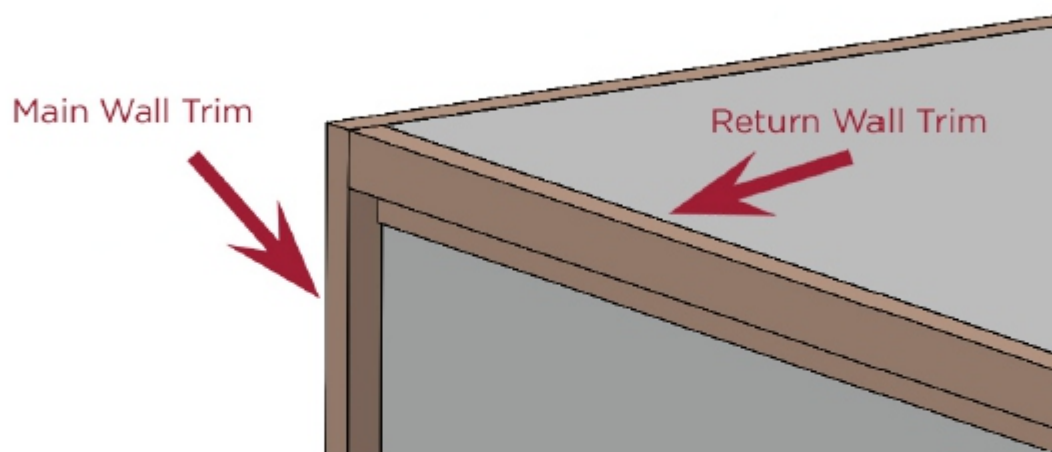
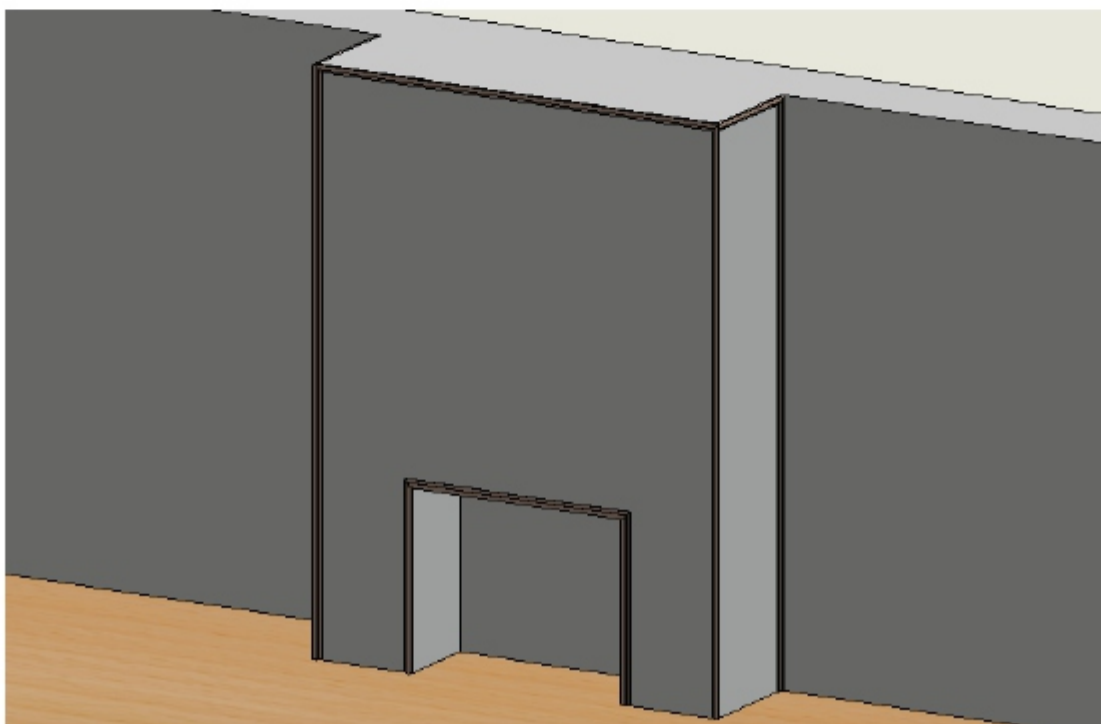

Figure A



## Panel Installation

2. Refer to the number sheet for exact locations of each numbered panel.
3. Beginning at the bottom, level and center the panels inside the vertical “J” trims. Secure the panels to the wall through the recessed flange at the top of the panel.

*Note: drilling holes through the mounting flange while the panels are in the upright position causes shavings to fall into the panel track, hindering proper installation of the next panel. It is recommended to pre-drill mounting holes and clean the track before placing the panels into position.*

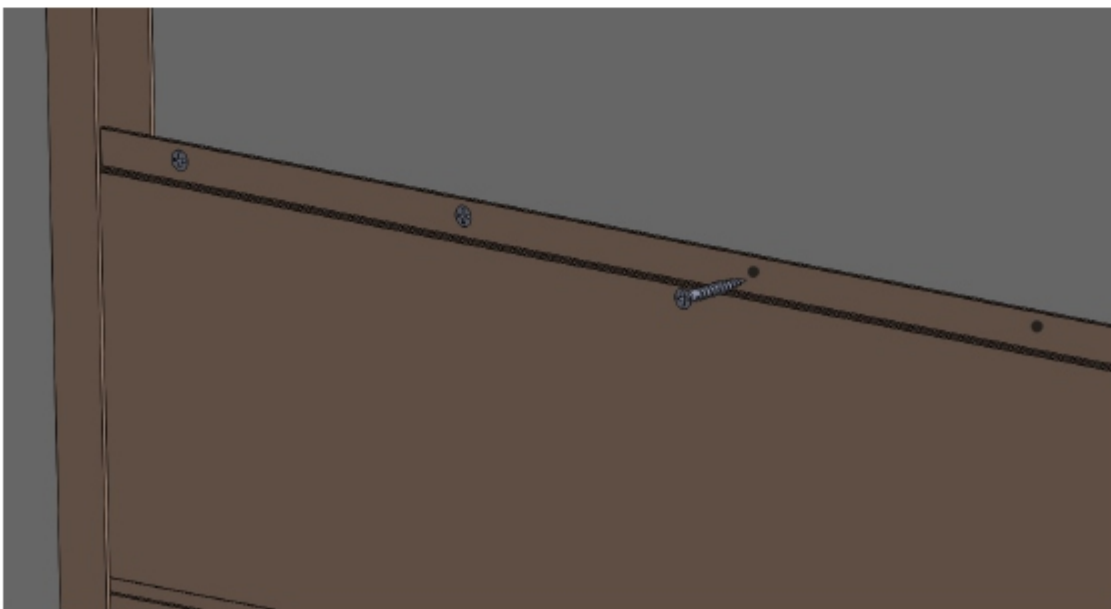

## Panel Installation

4. Repeat these steps for each row, until all panels are installed except the last row.

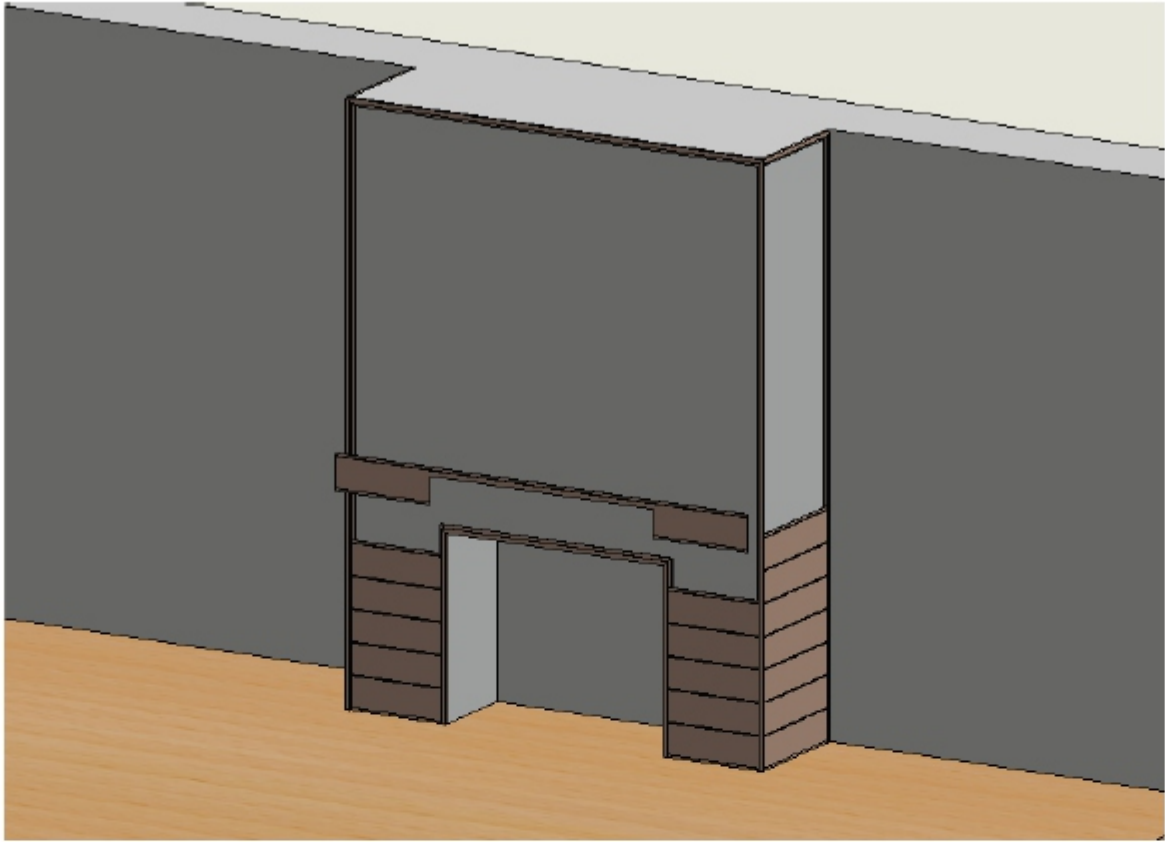

*Note: Verify Panels remain level as you go.*

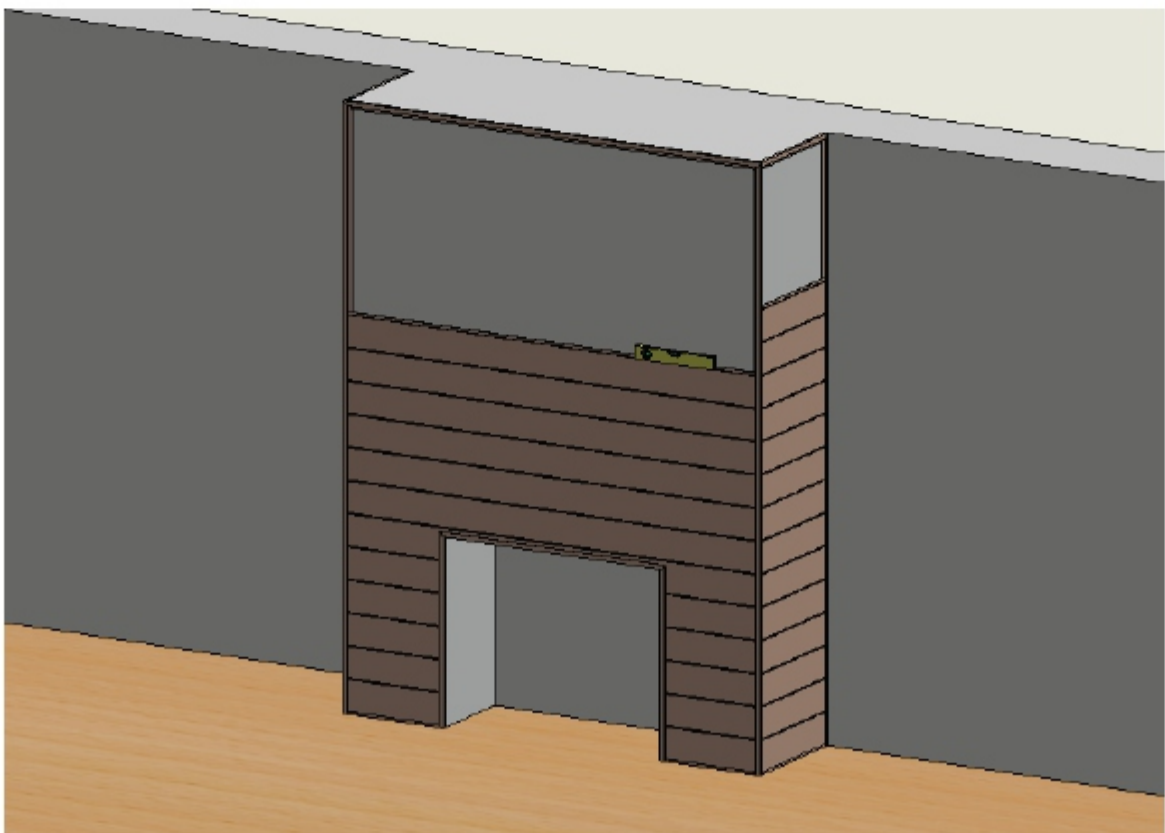

## Panel Installation

5. Install the final row of panels by inserting the panel into the top “J” trim, and pulling it down into the panel track below.

*Note: There is no need to secure this panel with screws, as it's held in place by the top “J” trim and shiplap panel below.*

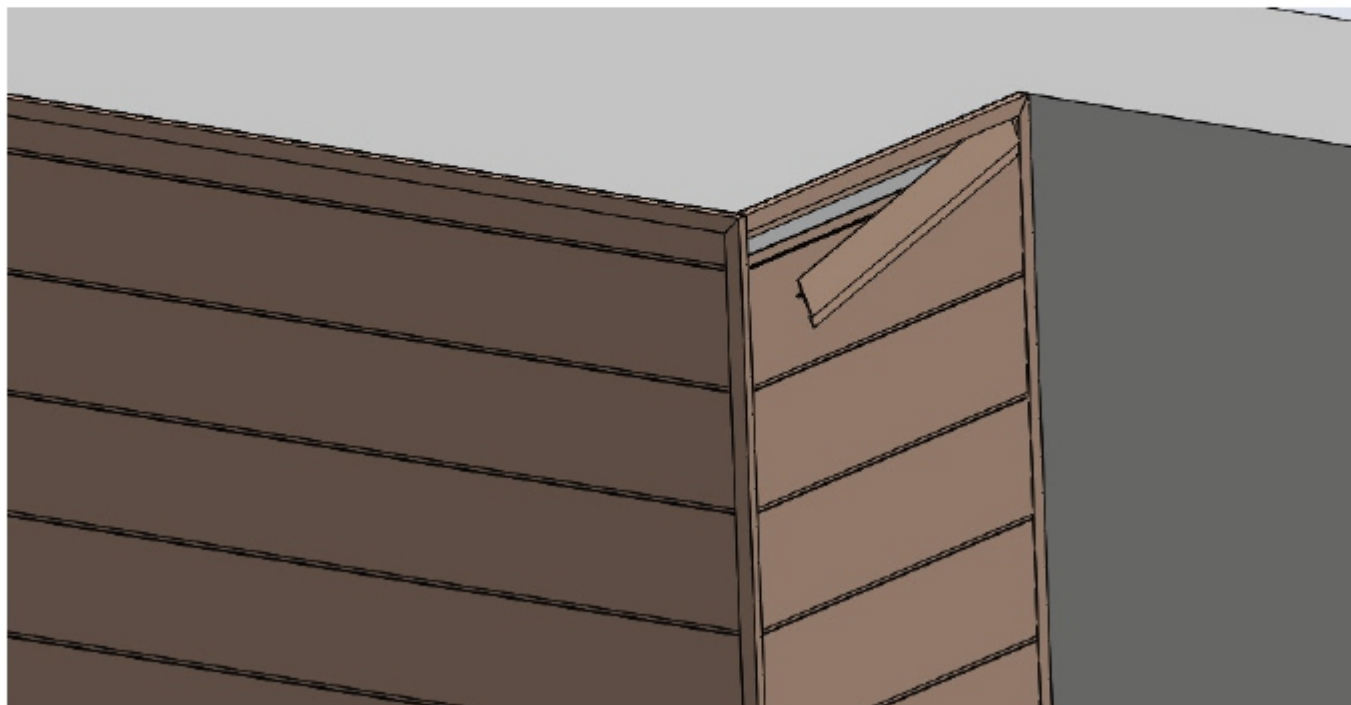

## Completion

Enjoy your finished product!

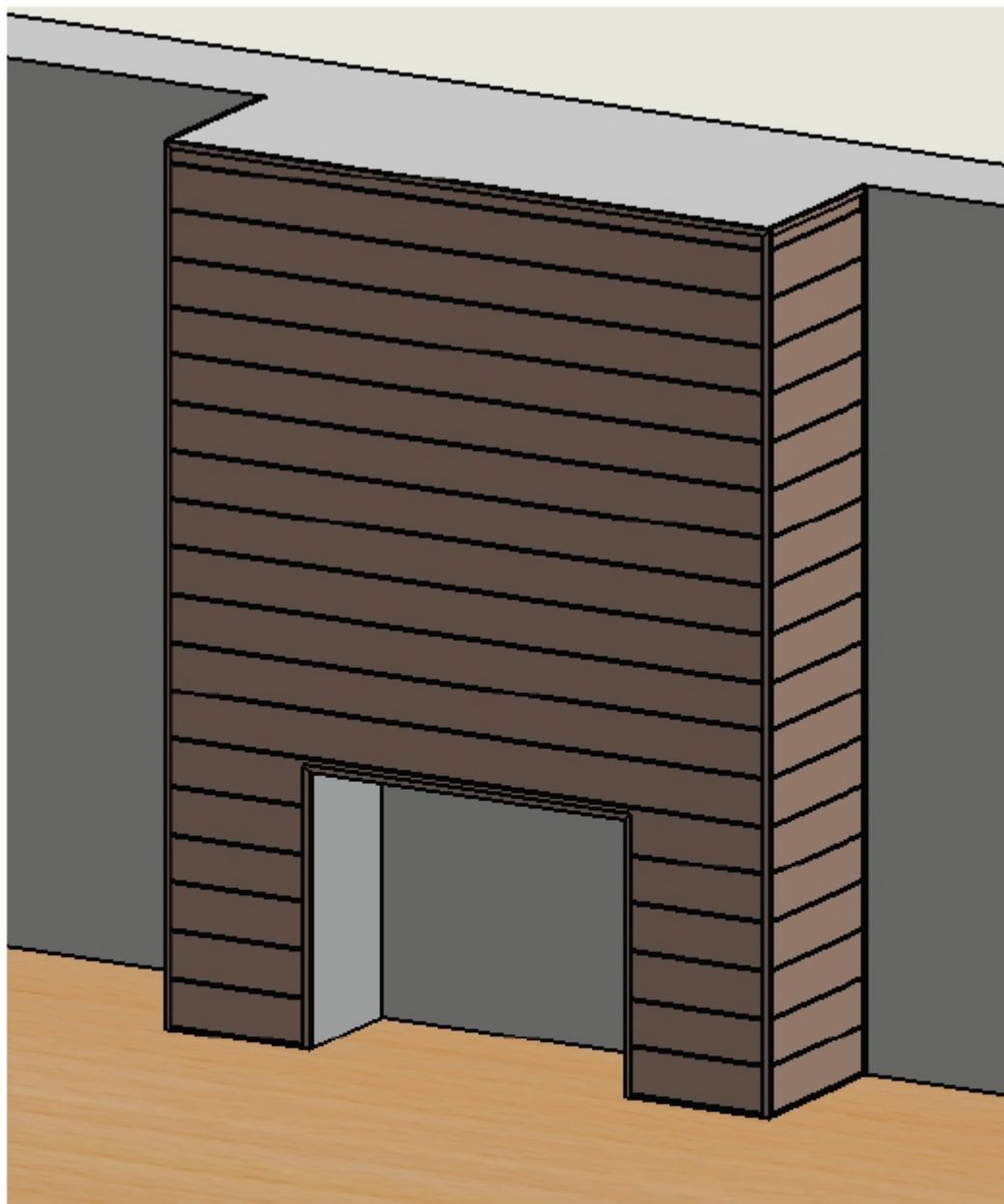

## Operation & Maintenance

- Excessive heat can cause damage to your product and the finish powdercoat. A very hot wood or gas fire, hot coals, embers, ashes, and/or logs coming in contact with the back of the product can cause discoloration or more serious damage. This type of damage, caused by overheating, is considered abuse and is not covered under warranty.
- Your Stoll product can be cleaned using a damp cloth, or mild household cleaner. To avoid damage to the finish, cleaners containing ammonia or other harsh chemicals should be avoided.



**HANSEN** WHOLESALe

[www.hansenwholesale.com](http://www.hansenwholesale.com) 1-800-201-1193